



# Eternity-III

## Medium Duty iKeypad Lock

www.ibuttonlock.com

### Hardware Spec

PARAMETER	DETAIL
Weight (Lock only)	2.2 Lbs
Working Current	250 mA
Idle Current	15 $\mu$ A
Motor Running Time	0.4 Second
Working Voltage	4.8-6.4V
Low Battery Warning	4.8V
Power Source	4 AA Alkaline Battery
Keypad	Weather Proof Keypad
Handle	Left or Right Hand
Door Thickness	1 3/8" to 2"
Keyway	SC 6 Pin
Dimension (1ps)	10 x 8 x 4 1/2"
Dimension (8pcs/box)	16 x 10 1/2 x 19"
Package Weight (1)	4.7 Lbs
Weight (8pcs/Box)	38 Lbs

### LOCK Front / Back



### Software Spec

Description	Software	Non-software
Audit Trail	Yes. 4,000	No
Users	800	299
Timed Operation	Yes	Yes
Remote Access	Yes	Yes
Storehouse/Classroom Mode	Yes	Yes
One Time User	Yes	Yes
Software Package	Yes	No
Lock from Inside	Yes	No
Set Up Method	Software	Keypad
Daylight Saving	Yes	Yes
Lock Out Function	Yes	Yes

### Ordering Information:

PART	DESCRIPTION	ACCESSORIES	DESCRIPTION
E3-SW	E3 Software Lock	D-1977	Programming Key
E3-NS	E3 Non-Software Lock	D-1994/1904	Clock Key
D-MC	Master Cylinder	D-1990	User Key
		USBPCA/UIBPCR	Programming Encoder
		iKeypad	Software CD

**Door Prep:**

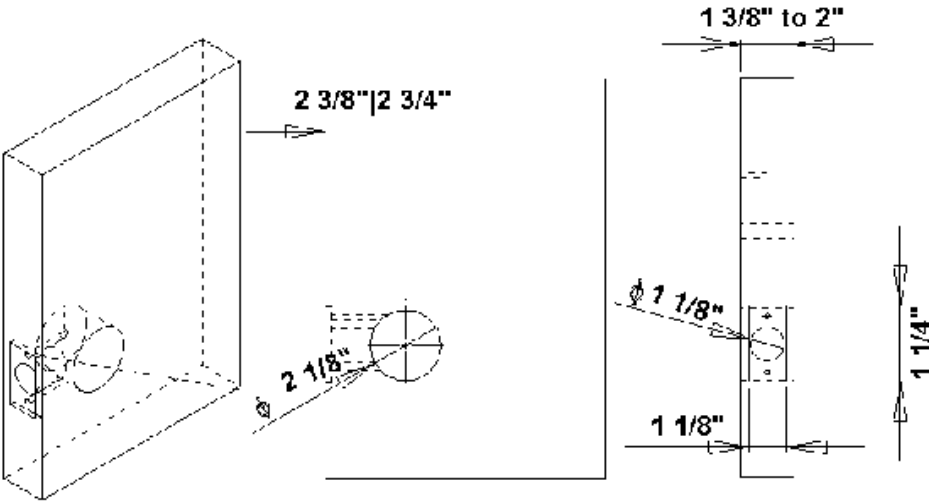

**Front View Installation:**

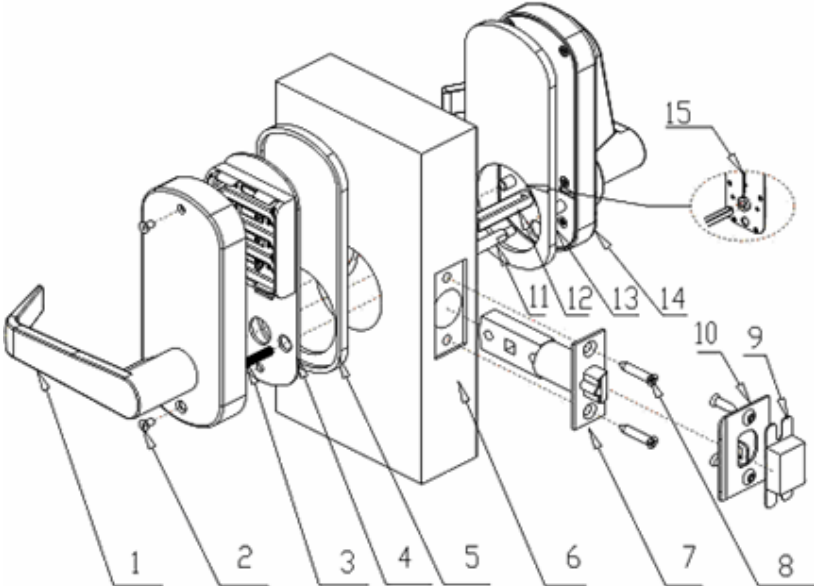

**Major Lock Parts:**

- 1. Back Handle
- 2. Back Cover Screws
- 3. Battery Plate Screws
- 4. Battery Plate
- 5. Back Rubber Gasket
- 6. Door
- 7. Latch
- 8. Latch Fix Screws
- 9. Dust Boot
- 10. Strike Plate
- 11. Front Lock Extension
- 12. Square Shaft
- 13. Front Rubber Gasket
- 14. Front Lock
- 15. Position Pin

# Eternity-III-Installation

**(We recommend to install the lock at unlock position.  
The Position Pin with the Dot on the lock housing is pointed up.)**

## Step 1

Insert the latch into door hole. Secure the latch with two fix screws.

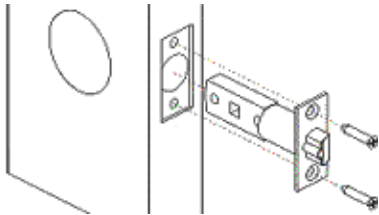

## Step 2

Insert square bar into front lock housing, **ensuring that the dot on the lock housing is pointed up.** Put pin into hole to secure the square bar with the front housing. Bend ends of pin around cylinder to lock the pin in place.

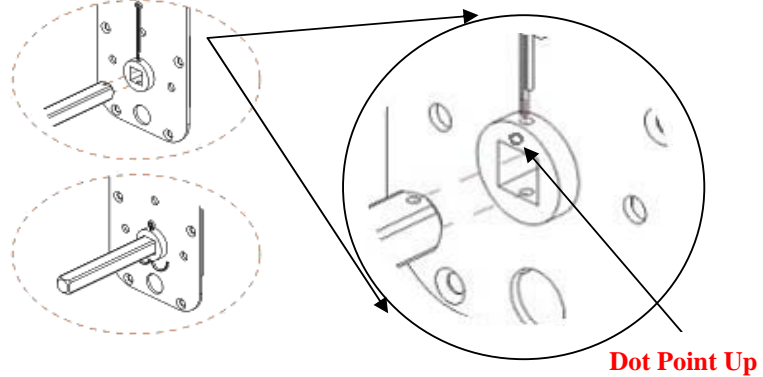

## Step 3

Take the screw extensions and screw into the holes on either side of the central cylinder housing.

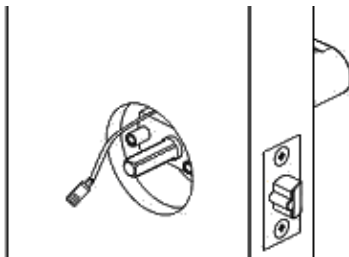

## Step 4

Place front lock housing in the door with the front rubber gasket between the door and housing while feeding the plug through the door.

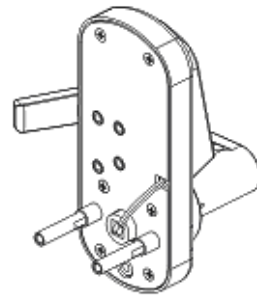

## Step 5

Attach the back battery unit to the door, first connecting the plug into the back unit, directly under the batteries. Fit back unit on the door, with the square bar going through the big hole, then fasten with 2 screws with the front extension pose.

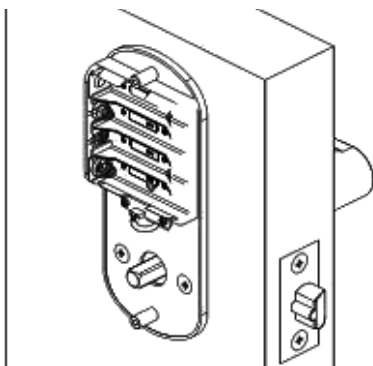

## Step 6

Put in batteries, then put the back lock housing over the battery unit. Fasten with 2 screws.

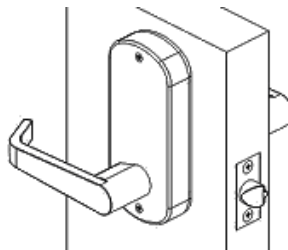

## Step 7

Put strike box in doorframe, and then strike plate over it.

